

LEGAL ADVERTISEMENT

Heidelberg Township is soliciting bids for timber owned by Heidelberg Township. The sale area is approximately 39.25 acres, located in Heidelberg Township, York County, Pennsylvania and contains approximately 4,874.1 tons of softwood pulpwood.

The Invitation to Bid and Specifications can be obtained from <https://heidelbergtwpmunicipal.com/legal-notices/> or by calling (717) 225-6606. A performance bond of \$2000.00 will be required. Sealed bids will be opened at a public meeting at 11:00 AM on Wednesday, August 3, 2022 at the Heidelberg Township Municipal Building, 6424 York Road, Spring Grove, PA 17362.

Heidelberg Township reserves the right to reject any or all bids or to award as it deems to be in the best interests of the Township.

HEIDELBERG TOWNSHIP

Julie Kutchi
Township Secretary

July 10, 2022

INVITATION TO BID

Ladies and Gentlemen:

Heidelberg Township is soliciting bids for timber owned by Heidelberg Township. The sale area is approximately 39.25 acres, located in Heidelberg Township, York County, Pennsylvania, containing approximately 4,874.1 tons of softwood pulpwood.

The property is located on Porters Road, Spring Grove, PA 17362. The coordinates to the landing site are 38° 49' 49.8017" N, 76° 53' 55.6420" W. The landing site is located 0.22 miles north of the intersection of Porters Road and Thoman Drive. **A sale tour will be held on July 27, 2022, at 9:30 AM.** A map showing the timber sale location is attached. Please call if you have any questions.

Copies of the Specifications and the Bid Form are enclosed. All bids must be submitted on the Bid Form provided by Heidelberg Township.

Bid opening will occur at a public meeting at 11:00 AM on Wednesday, August 3, 2022 at the Heidelberg Township Municipal Building, 6424 York Road, Spring Grove, PA 17362. If the Board of Supervisors deems appropriate, bid award will occur at its regular meeting scheduled for 7:00 PM, Wednesday, **August 3, 2022** at Porters Sideling Fire Company, 1199 Porters Road, Spring Grove, PA 17362.

All bids must be plainly marked "**TIMBER SALE**" and be submitted in sealed envelopes to the Heidelberg Township, 6424 York Road, Spring Grove, PA 17362 no later than 11:00 AM on the date of the opening.

Heidelberg Township reserves the right to reject any or all bids or to award as it deems to be in the best interests of the Township.

Truly yours,

HEIDELBERG TOWNSHIP

Julie Kutchi
Township Secretary

SPECIFICATIONS

APPENDIX A

INSURANCE REQUIREMENTS

The following minimum limits are required:

	State Requirements
1. Workmen's Compensation	
2. Automobile/Truck Liability	
Bodily Injury	\$1,000,000 each person \$1,000,000 each occurrence
Property Damage	\$1,000,000 each occurrence
3. General Liability	
Bodily Injury	\$2,000,000 each occurrence
Property Damage	\$2,000,000 each occurrence

Certificates confirming this coverage listing owners as additional insured are required prior to any harvesting activity on the property.

SPECIAL PAYMENT CONSIDERATIONS:

The following payment schedule will be accepted:

1. An initial payment of 25% of the total timber bid shall be due at the signing of the Timber Conveyance.

The successful bidder will have 7 days following the bid opening to execute the Timber Conveyance.

2. A payment of 25% of the total timber bid shall be due on or before October 3, 2022.

3. The final net payment of 50% of the total timber bid shall be due on or before December 23, 2022.

In the event of the timber harvesting starting prior to the scheduled net payments, the total net timber bid amount shall be due.

APPENDIX B

HARVESTING -

Residual trees to be **KEPT** are marked with a **YELLOW** band with a dot on the stump. The outside sale boundary lines are painted with three slashes and may not be cut. An inventory cruise was utilized to estimate softwood pulpwood tonnage. Volumes were estimated using a 10 BAF prism cruise and are not guaranteed. Bidders should estimate volumes to their own satisfaction.

All due care must be taken by Buyer to minimize damage to those trees that are not designated in this conveyance to be removed. A monetary penalty shall be assessed for excessive damage at the discretion of Owner's Agents, Timber Ridge Forestry, LLC.

Tops shall be kept within the owner's boundaries and shall be cut down to within 4 feet of ground level.

The landing area must be graded, seeded, and mulched. All skid trails shall be graded, and water bars installed at designated areas. All blocks and debris must be removed from the landing area.

Logging equipment must be power washed before moving onto the job site to help prevent the spread of invasive plant species.

Timber Ridge Forestry, LLC will prepare an Erosion Control Plan for the Buyer. Any and all other permits, bonds, agreements, etc. as required by Township, County, State or Federal agencies are the sole responsibility of the Buyer. Buyer is required to call 811 prior to moving equipment onto the property.

The successful bidder will have 7 days following the bid opening to execute the Timber Conveyance. Payment will be due at that time.

This Timber Conveyance is not assignable without the written consent of the Owner. Buyer shall notify Timber Ridge Forestry, LLC at least ten days prior to any harvesting activity.

All harvesting and site retirement must be completed by **September 22, 2023**. No harvesting activity will be allowed on the property from April 1st through July 1st each year of the contract.

The successful bidder will be required to provide a performance deposit of \$2,000 which will be held to insure proper execution of the contract. The performance deposit will be returned following successful completion and retirement of the harvest. The Owners reserve the right to reject any and all bids.

TOTAL VOLUME by DBH

STAND 1

Sampling Method: Variable Radius Plots

ACRES 39.3

Basal Area Factor: 10.00

pulpwood

Tone	TOTAL	4	6	8	10	12	14	16	18	20	22	24	26	28	30	32+
SW Pulpwood	VOL 4,874.1		1,993.2	1,536.8	985.3	283.5	75.3									
	TREES 21,442.2		11,724.8	6,681.7	2,463.4	480.5	91.8									
TOTAL	VOL 4,874.1		1,993.2	1,536.8	985.3	283.5	75.3									
	TREES 21,442.2		11,724.8	6,681.7	2,463.4	480.5	91.8									

Timber Ridge Forestry, LLC
 717-487-3936
 222 John Street
 Hanover, PA 17331



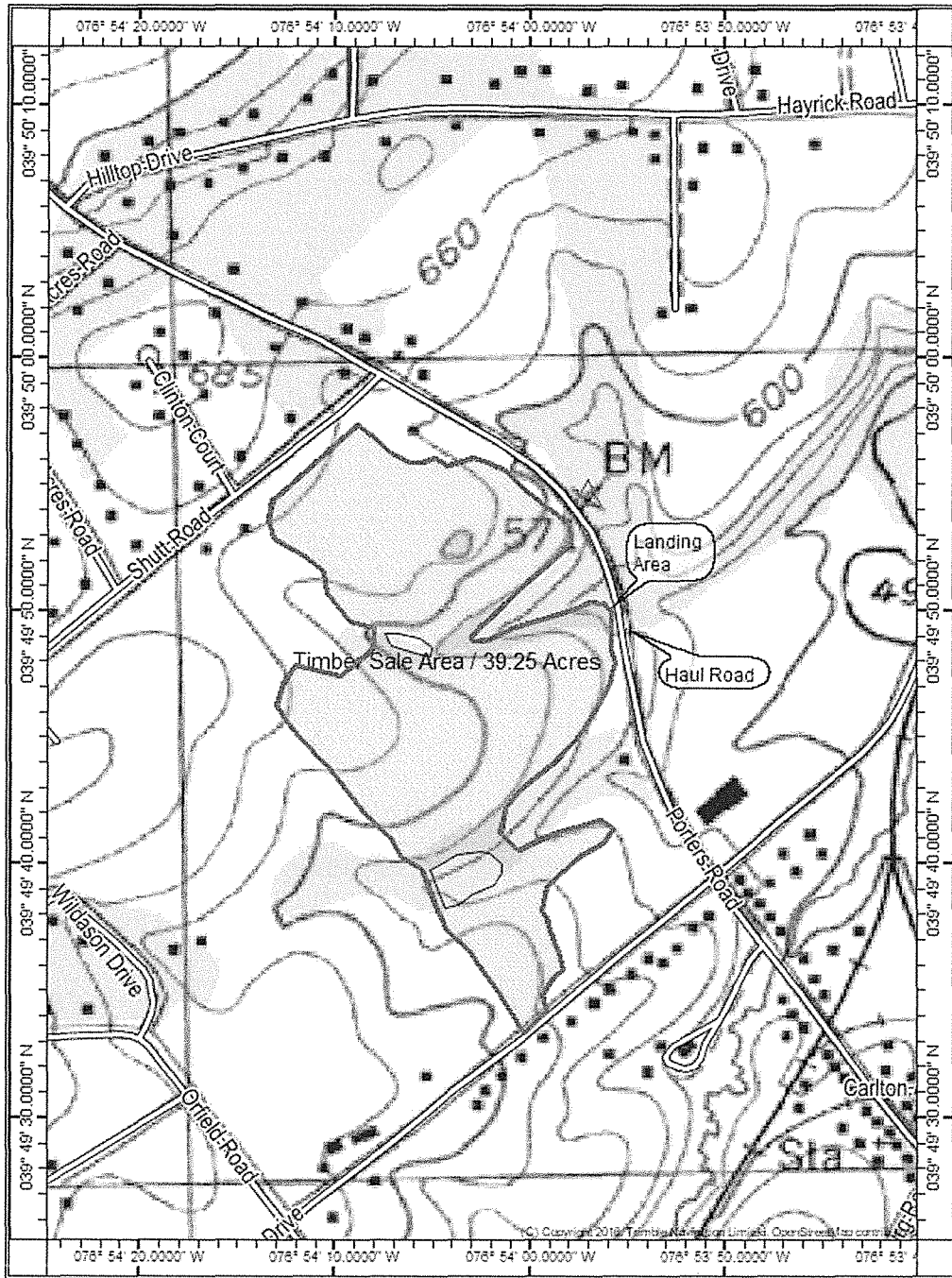

Declination
 ★
 MN GN
 GN 1.21° W
 MN 11.93° W

Heidelberg Township
 Timber Sale Map
 Heidelberg Township
 York County, PA

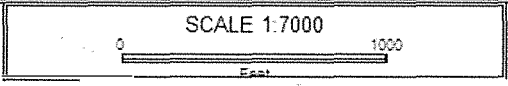

TIMBER SALE BID FORM

OWNER: **Heidelberg Township**
LOCATION: **Heidelberg Township, York County, PA**
BID DUE BY: **Wednesday, August 3, 2022 at 11:00 AM**

I hereby submit a lump sum bid for the timber described within the Invitation to Bid and Specifications:

_____ Dollars

\$ _____
(Please use both lines)

COMPANY: _____

BY: _____
(Signature)

ADDRESS: _____

PHONE: _____ FAX: _____